

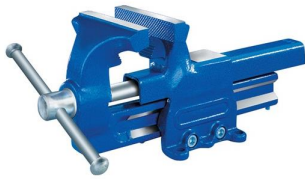

Our retail price is a recommendation only. Prices in offer may differ. All prices indicated 0,00 € will follow in the offer.

**PROMAT PARALLEL VICE JAW WIDTH
100 MM CLAMPING WIDTH 125 MM
FORGED CLAMP DEPTH 55 MM**

SKU: 4015448478522



Parallel vice jaw width 100 mm clamping
width 125 mm forged clamp depth 55 mm

Categories: [Clamping tools](#), [Parallel vices
and accessories](#)

Product Features: Width of jaw: 100 mm
Clamping width: 125 mm
Clamp depth: 55 mm
Type: Forged
Brand: PROMAT

Scope of delivery:
1,00 ST Parallel vice jaw width 100 mm
clamping width 125 mm forged clamp depth
55 mm |

PRODUCT DESCRIPTION

With 2 pipe forged pipe clamp jaws

- Forged
- Anvil surface for aligning and compressing work
- Milled clamping jaws
- Induction-hardened
- (HRC 54-58)
- Re-adjustable guide
- Theft-protection as a result of removable frontal jaw part
- Vice opening to the front
- Compatible accessories: Swivel plate see article no. 4000 830 360, 4000 830 361, 4000 830 362, 4000 830 363 Elevators see article no. 4000 830 366, 4000 830 367, 4000 830 368 Further technical information:
- Weight: 5kg
- Hole distance: 72 x 58mm
- Bore Ø: 10.0mm
- Size of anvil (axb): 38 x 40mm



- Overall length: 422.5mm

PRODUCT DATASHEET LEGAL NOTE

Please note that the information on this datasheet is provided without warranty and is intended only as non-binding information about the product. Any liability for damages or losses that may arise from the use of this information is excluded. We therefore recommend that you verify the information on this datasheet with other sources before making any decisions based on this information. Additional information about the product can be found on our website.